

H 7180 BP

30" Convection Oven - ContourLine

Features:

- DirectSensor S - Intuitive touch controls
- Miele@Home - Control the appliances with your app
- Self Cleaning Oven
- Automatic programs - easily master new recipes

Included:

- 1 Universal baking tray
- 1 Self Clean Ready Baking and Roasting Rack with Perfect Clean
- 1 Self Clean Ready Rack with rail system



MATERIAL

11805340

SPECIFICATIONS	
Overall Unit Dimensions	29 ¹³ / ₁₆ " (757 mm) W x 28 ⁵ / ₈ " (727 mm) H x 23 ³ / ₄ " (603 mm) D
Niche	
Minimum Cabinet Niche Opening	28 ¹ / ₂ " (724 mm) W x 28 ¹ / ₄ " (718 mm) H x 24" (610 mm) D
Electrical	
Electrical Requirements	120/208-240V, 60Hz, 30 Amps
Power Cord	NEMA 14-30 plug, 5 ft (1.52 m)
Shipping	
Shipping Weight	215 lbs (98 kg)
Shipping Dimensions	30 ⁷ / ₁₆ " (776 mm) W x 35 ³ / ₄ " (907 mm) H x 32 ¹⁵ / ₁₆ " (836 mm) D

PRODUCT DIMENSIONS

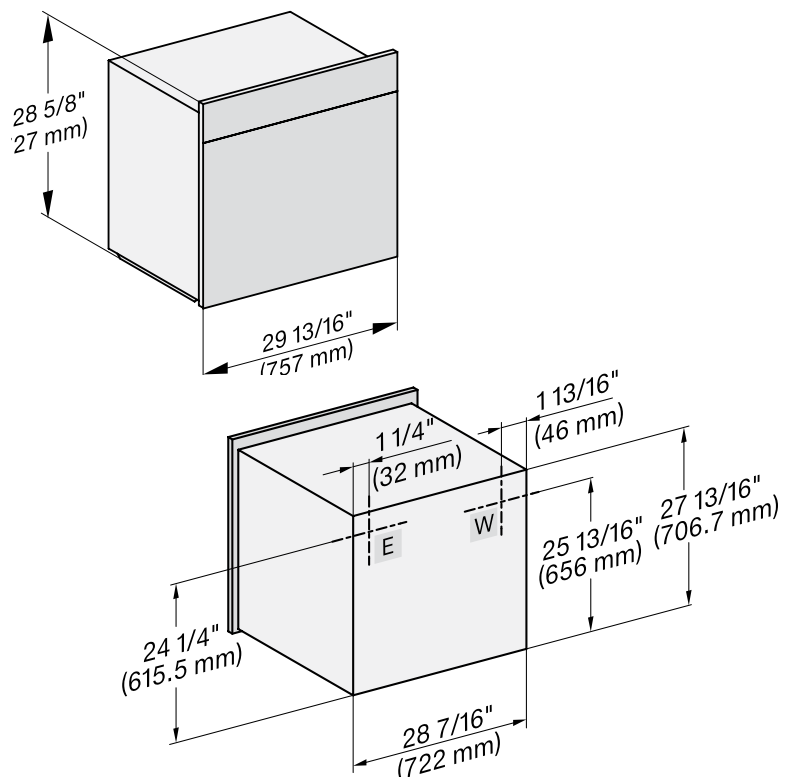

E = Electrical Connection

W = This unit does not have a water connection

FLUSH CUTOUT DIMENSIONS

Front View

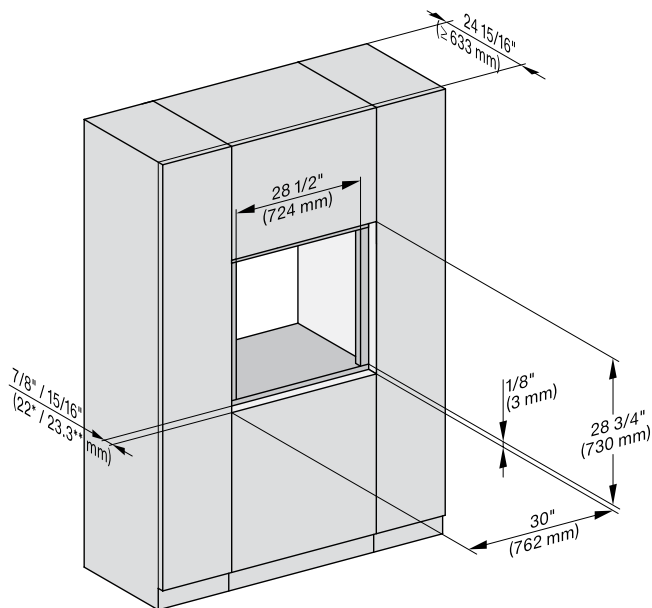

Side View

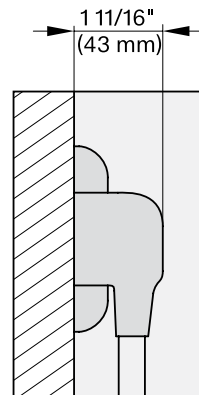
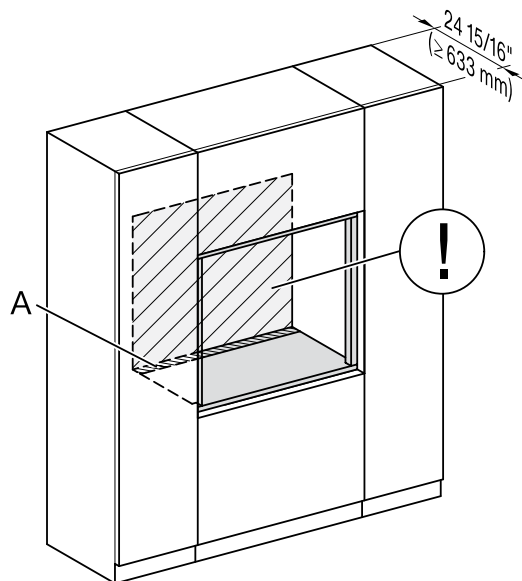
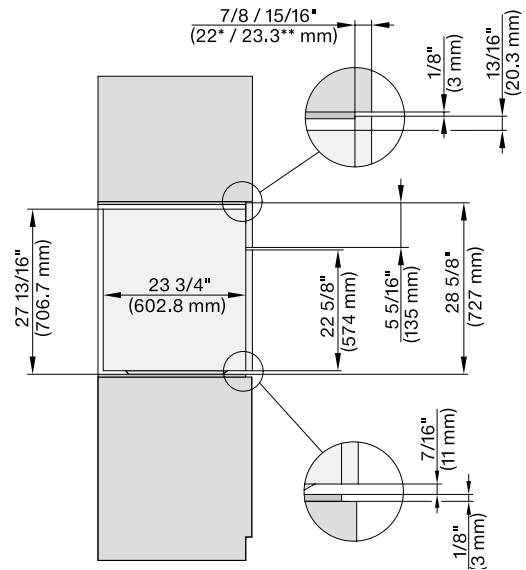

A - Cut-out (4" x 28" [100 mm x 720 mm]) in the bottom of the cabinet for the power cord and Ventilation

ⓘ - Electrical supplies are recommended to be placed in adjacent cabinetry.

Additional cabinet depth is required when placing the electrical supplies behind the appliance.

PROUD CUTOUT DIMENSIONS

Front View

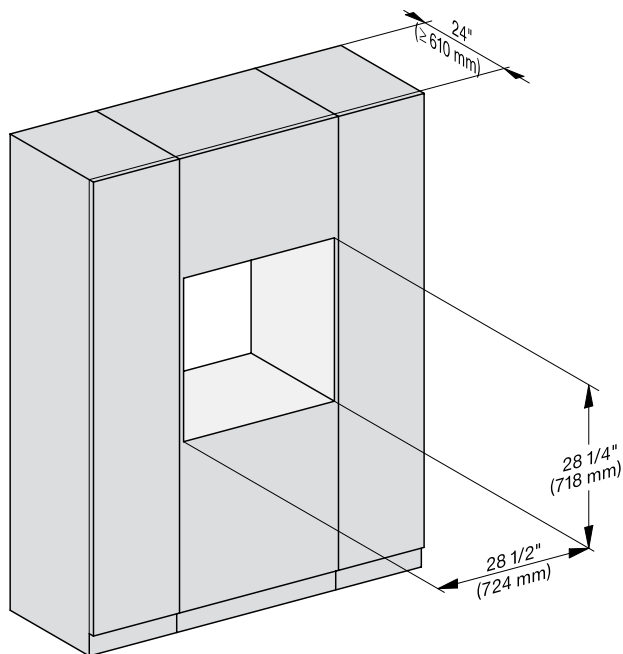

Side View

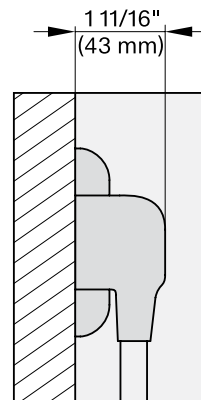
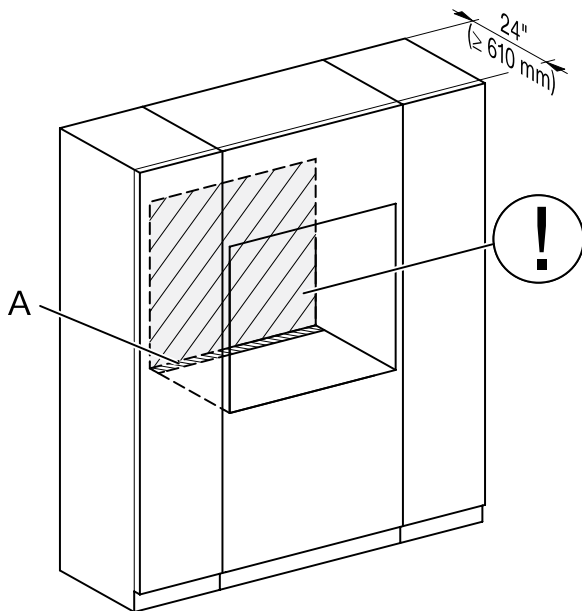
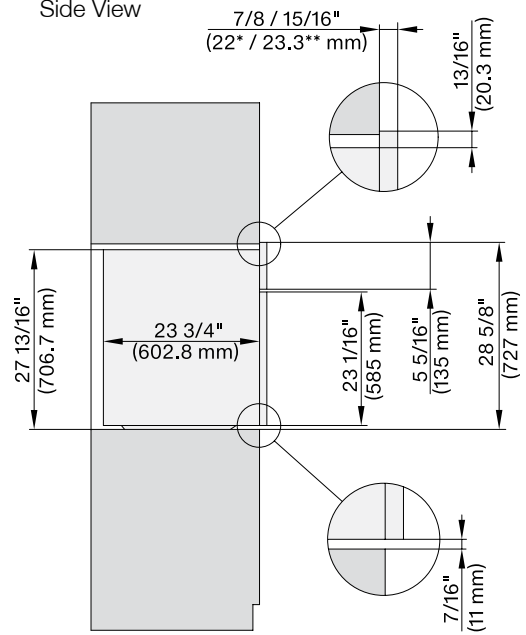

A - Cut-out (4" x 28" [100 mm x 720 mm]) in the bottom of the cabinet for the power cord and Ventilation

ⓘ - Electrical supplies are recommended to be placed in adjacent cabinetry.

Additional cabinet depth is required when placing the electrical supplies behind the appliance.